

Weight (lbs)	DA	13.5
	SR	15.0
Volume (in <sup>3</sup> per 90°)	CW	79.9
	CCW	61.6
Cycle Time (seconds per 90°)	DA	1.5
	SR	1.5

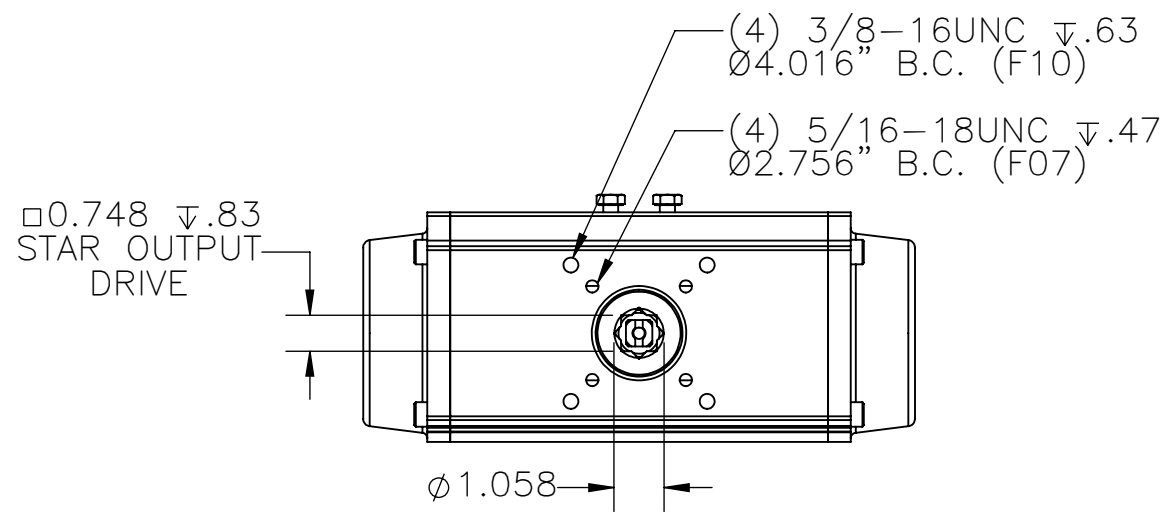

3R200 Output Torque (in\*lbs) per Air Supply (psi)

	Springs per Side	Spring Torque		40 psi		60 psi		80 psi		100 psi		120 psi	
		End	Break	End	Break	End	Break	End	Break	End	Break	End	Break
	2	212	330	431	548	811	929	1192	1309	1572	1690	-	-
	3	319	495	266	442	646	823	1027	1203	1407	1584	-	-
	4	425	660	101	336	481	716	862	1097	1242	1477	-	-
	5	531	825	-	-	316	610	697	991	1077	1371	-	-
	6	637	990	-	-	151	504	532	884	912	1265	-	-
	Double Acting	-		761		1141		1522		1902		2283	

Direct Acting:  
 Pressure at port P1 will result in a clockwise rotation  
 Pressure at port P2 will result in a counter-clockwise rotation  
 Reverse Acting:  
 Pressure at port P1 will result in a counter-clockwise rotation  
 Pressure at port P2 will result in a clockwise rotation

NOTES: Accessory mounting holes are not intended for Manual Gear Overrides or Stop Blocks. Cycle times are under no load conditions. Air line size, air capacity, and valve torque characteristics affect these cycle times. Faster or slower cycle times can be accomplished using special control components.

	9955 INTERNATIONAL BLVD. CINCINNATI, OHIO 45246 PHONE: (513) 247-5465 FAX: (513) 247-5462	DRAWN BY SJK DATE 07/07/21	CHECKED BY NPM DATE 07/08/21	RELEASED BY NPM DATE 07/08/21	<b>VALVES, ACTUATORS, AND AUTOMATION CONTROLS</b>	SHEET 1 of 1	
	DO NOT SCALE DRAWING	DESCRIPTION 3R200 DIMENSIONAL DRAWING AND TORQUE DATA				MATERIAL	DRAWING NO. <b>P03913</b>

THE DESIGN AND DISCLOSURE CONTAINED IN THIS DRAWING WAS ORIGINATED BY, AND IS EXCLUSIVE PROPERTY OF A-T CONTROLS, INC. IT IS FURNISHED FOR VENDOR INFORMATION ONLY AND IS NOT AN AUTHORIZATION OR LICENSE TO MAKE THIS CONSTRUCTION OR TO FURNISH THIS INFORMATION TO OTHERS. ALL DRAWINGS MUST BE RETURNED TO A-T CONTROLS, INC. ON DEMAND. THIS DRAWING IS NOT TO BE REPRODUCED OR COPIED IN ANY FORM WITHOUT THE EXPRESS WRITTEN PERMISSION OF A-T CONTROLS, INC.