

Weight (lbs)	DA	10.5
	SR	11.8
Volume (in ³ per 90°)	CW	60.4
	CCW	42.1
Cycle Time (seconds per 90°)	DA	1.2
	SR	1.2

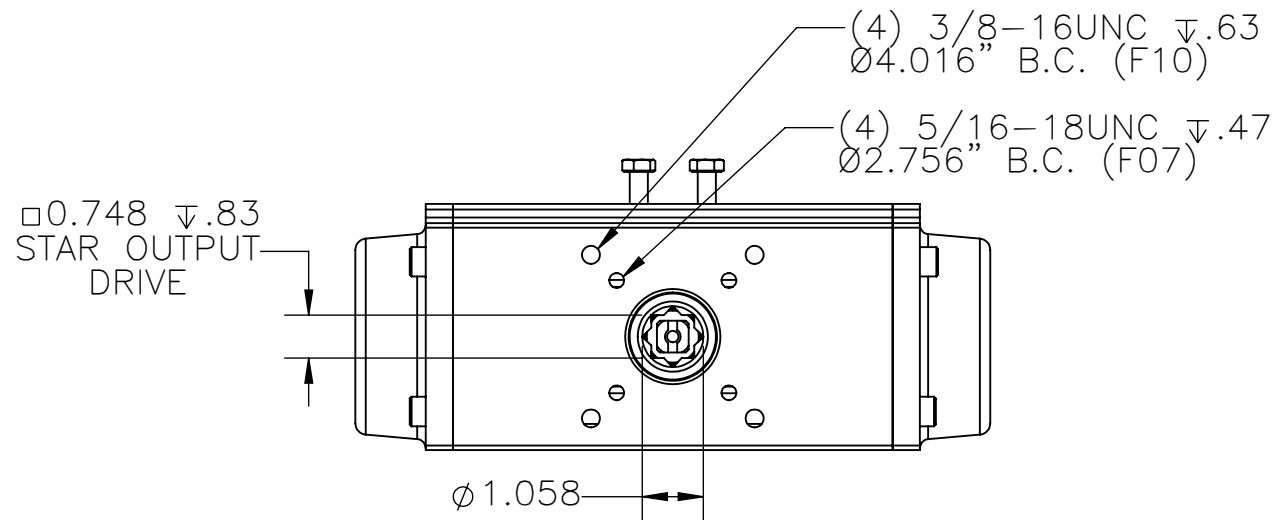

3R130 Output Torque (in*lbs) per Air Supply (psi)

	Springs per Side	Spring Torque		40 psi		60 psi		80 psi		100 psi		120 psi	
		End	Break	End	Break	End	Break	End	Break	End	Break	End	Break
	2	156	231	295	369	558	632	821	895	1084	1158	-	-
	3	265	346	180	291	443	554	706	817	968	1080	-	-
	4	313	461	65	213	327	476	590	739	853	1002	-	-
	5	391	576	-	-	212	398	475	661	738	923	-	-
	6	469	692	-	-	97	320	360	582	623	845	-	-
	Double Acting	-		526		789		1051		1314		1577	

Direct Acting:
 Pressure at port P1 will result in a clockwise rotation
 Pressure at port P2 will result in a counter-clockwise rotation
 Reverse Acting:
 Pressure at port P1 will result in a counter-clockwise rotation
 Pressure at port P2 will result in a clockwise rotation

NOTES: Accessory mounting holes are not intended for Manual Gear Overrides or Stop Blocks. Cycle times are under no load conditions. Air line size, air capacity, and valve torque characteristics affect these cycle times. Faster or slower cycle times can be accomplished using special control components.



9955 INTERNATIONAL BLVD.
 CINCINNATI, OHIO 45246
 PHONE: (513) 247-5465
 FAX: (513) 247-5462

DRAWN BY SJK CHECKED BY NPM RELEASED BY NPM
 DATE 07/07/21 DATE 07/08/21 DATE 07/08/21

VALVES, ACTUATORS, AND AUTOMATION CONTROLS

SHEET 1 of 1

DO NOT SCALE DRAWING

DESCRIPTION
 3R130 DIMENSIONAL DRAWING AND TORQUE DATA

MATERIAL
 DRAWING NO. P03916
 REVISION

THE DESIGN AND DISCLOSURE CONTAINED IN THIS DRAWING WAS ORIGINATED BY, AND IS EXCLUSIVE PROPERTY OF A-T CONTROLS, INC. IT IS FURNISHED FOR VENDOR INFORMATION ONLY AND IS NOT AN AUTHORIZATION OR LICENSE TO MAKE THIS CONSTRUCTION OR TO FURNISH THIS INFORMATION TO OTHERS. ALL DRAWINGS MUST BE RETURNED TO A-T CONTROLS, INC. ON DEMAND. THIS DRAWING IS NOT TO BE REPRODUCED OR COPIED IN ANY FORM WITHOUT THE EXPRESS WRITTEN PERMISSION OF A-T CONTROLS, INC.