

Weight (lbs)	DA	54.1
	SR	61.6
Volume (in ³ per 90°)	CW	392.4
	CCW	283.1
Cycle Time (seconds per 90°)	DA	3.5
	SR	3.5

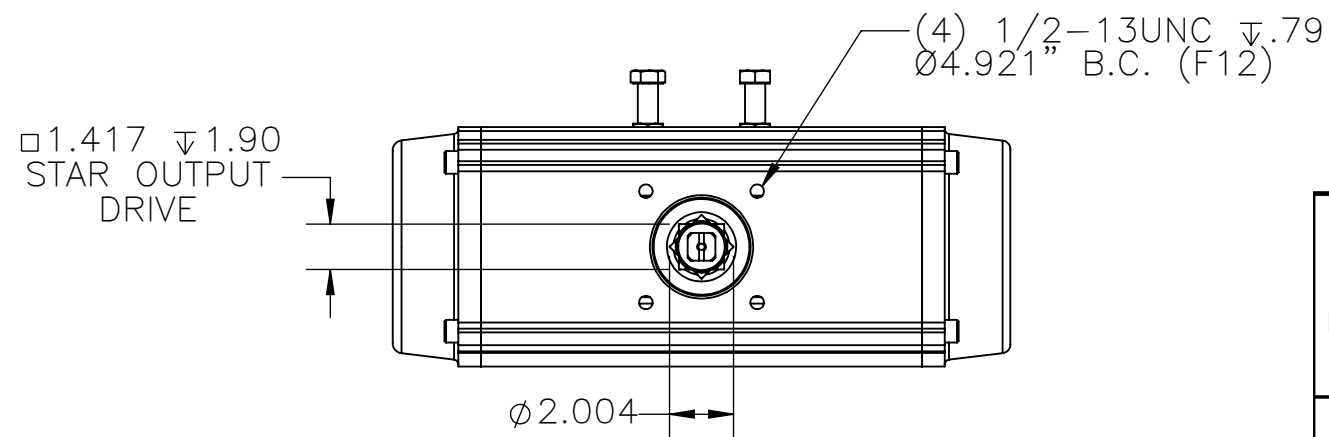

3R1000 Output Torque (in*lbs) per Air Supply (psi)

	Springs per Side	Spring Torque		40 psi		60 psi		80 psi		100 psi		120 psi	
		End	Break	End	Break	End	Break	End	Break	End	Break	End	Break
	2	1064	1597	2102	2635	3952	4484	5801	6334	7650	8183	-	-
	3	1596	2395	1304	2103	3153	3952	5003	5802	6852	7651	-	-
	4	2128	3193	505	1571	2355	3420	4204	5269	6054	7119	-	-
	5	2660	3992	-	-	1557	2888	3406	4737	5255	6587	-	-
	6	3192	4790	-	-	758	2356	2608	4205	4457	6055	-	-
	Double Acting	-		3699		5548		7398		9247		11097	

Direct Acting:
 Pressure at port P1 will result in a clockwise rotation
 Pressure at port P2 will result in a counter-clockwise rotation
 Reverse Acting:
 Pressure at port P1 will result in a counter-clockwise rotation
 Pressure at port P2 will result in a clockwise rotation

NOTES: Accessory mounting holes are not intended for Manual Gear Overrides or Stop Blocks. Cycle times are under no load conditions. Air line size, air capacity, and valve torque characteristics affect these cycle times. Faster or slower cycle times can be accomplished using special control components.



9955 INTERNATIONAL BLVD.
 CINCINNATI, OHIO 45246
 PHONE: (513) 247-5465
 FAX: (513) 247-5462

DRAWN BY SJK CHECKED BY NPM RELEASED BY NPM
 DATE 07/28/21 DATE 07/30/21 DATE 07/30/21

VALVES, ACTUATORS, AND AUTOMATION CONTROLS

SHEET 1 of 1

DO NOT SCALE DRAWING

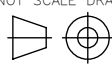

DESCRIPTION
 3R1000 DIMENSIONAL DRAWING AND TORQUE DATA

MATERIAL
 DRAWING NO. P03925
 REVISION

THE DESIGN AND DISCLOSURE CONTAINED IN THIS DRAWING WAS ORIGINATED BY, AND IS EXCLUSIVE PROPERTY OF A-T CONTROLS, INC. IT IS FURNISHED FOR VENDOR INFORMATION ONLY AND IS NOT AN AUTHORIZATION OR LICENSE TO MAKE THIS CONSTRUCTION OR TO FURNISH THIS INFORMATION TO OTHERS. ALL DRAWINGS MUST BE RETURNED TO A-T CONTROLS, INC. ON DEMAND. THIS DRAWING IS NOT TO BE REPRODUCED OR COPIED IN ANY FORM WITHOUT THE EXPRESS WRITTEN PERMISSION OF A-T CONTROLS, INC.