

Weight (lbs)	DA	160.9
	SR	201.7
Volume (in ³ per 90°)	CW	1468.2
	CCW	1064.9
Cycle Time (seconds per 90°)	DA	10.0
	SR	10.0

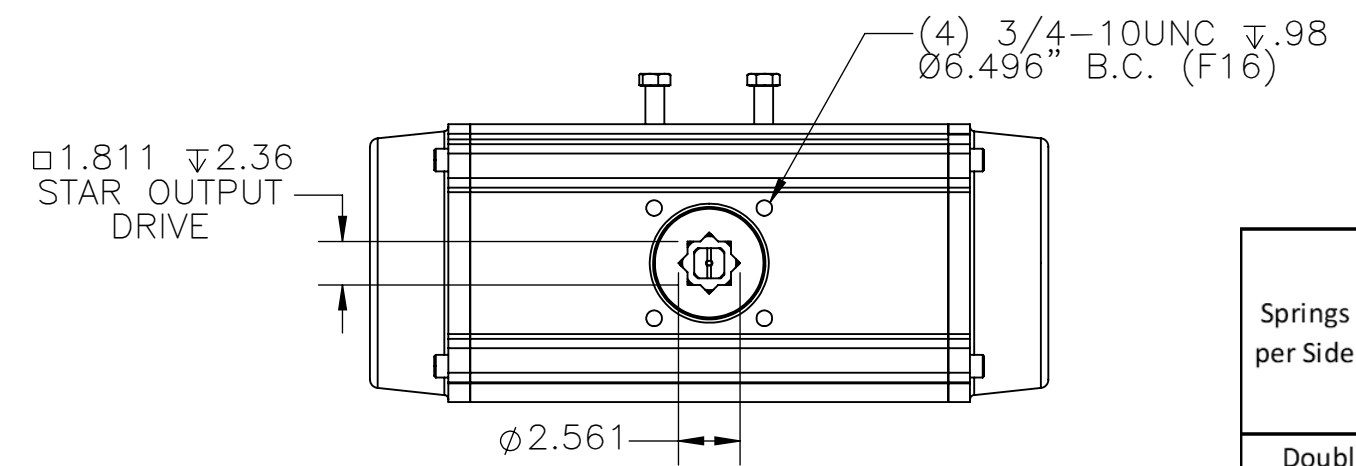

3R2700 Output Torque (in*lbs) per Air Supply (psi)

Springs per Side		Spring Torque		40 psi		60 psi		80 psi		100 psi		120 psi	
		End	Break	End	Break	End	Break	End	Break	End	Break	End	Break
		2	3,756	5,278	8,307	9,829	15,099	16,621	21,891	23,413	28,683	30,205	-
3	5,634	7,917	5,668	7,951	12,460	14,743	19,252	21,535	26,044	28,327	-	-	
4	7,512	10,556	3,029	6,073	9,821	12,865	16,613	19,567	23,405	26,449	-	-	
5	9,390	13,195	-	-	7,182	10,987	13,974	17,779	20,766	24,571	-	-	
6	11,268	15,834	-	-	4,543	9,109	11,335	15,901	18,127	22,693	-	-	
Double Acting		-		13,584		20,377		27,169		33,961		40,753	

Direct Acting:
 Pressure at port P1 will result in a clockwise rotation
 Pressure at port P2 will result in a counter-clockwise rotation
 Reverse Acting:
 Pressure at port P1 will result in a counter-clockwise rotation
 Pressure at port P2 will result in a clockwise rotation

NOTES: Accessory mounting holes are not intended for Manual Gear Overrides or Stop Blocks. Cycle times are under no load conditions. Air line size, air capacity, and valve torque characteristics affect these cycle times. Faster or slower cycle times can be accomplished using special control components.

	9955 INTERNATIONAL BLVD. CINCINNATI, OHIO 45246 PHONE: (513) 247-5465 FAX: (513) 247-5462	DRAWN BY SJK DATE 07/30/21	CHECKED BY NPM DATE 07/30/21	RELEASED BY NPM DATE 07/30/21	VALVES, ACTUATORS, AND AUTOMATION CONTROLS	SHEET 1 of 1	
	DO NOT SCALE DRAWING 	DESCRIPTION 3R2700 DIMENSIONAL DRAWING AND TORQUE DATA				MATERIAL	DRAWING NO. P03939

THE DESIGN AND DISCLOSURE CONTAINED IN THIS DRAWING WAS ORIGINATED BY, AND IS EXCLUSIVE PROPERTY OF A-T CONTROLS, INC. IT IS FURNISHED FOR VENDOR INFORMATION ONLY AND IS NOT AN AUTHORIZATION OR LICENSE TO MAKE THIS CONSTRUCTION OR TO FURNISH THIS INFORMATION TO OTHERS. ALL DRAWINGS MUST BE RETURNED TO A-T CONTROLS, INC. ON DEMAND. THIS DRAWING IS NOT TO BE REPRODUCED OR COPIED IN ANY FORM WITHOUT THE EXPRESS WRITTEN PERMISSION OF A-T CONTROLS, INC.